



# INSTALLATION INSTRUCTIONS

## BLOW-OFF VALVE CONVERSION KIT

### DODGE SRT-4/CHRYSLER PT TURBO

PART NUMBER P4510548

#### BLOW-OFF VALVE CONVERSION KIT COMPONENTS

- (One) Blow-Off Plate
- (One) Gasket
- (Three) Screws w/washers M6 X 1 X 25

#### SRT-4 INSTALLATION

- (1) Disconnect and remove the battery from the vehicle (Fig. 1).
- (2) Remove the clean air hose (Fig. 2).
- (3) Disconnect the surge valve vacuum hose at the rear underside of the turbo (Fig. 6).
- (4) Remove the three attaching bolts that secure the surge valve to the turbo.
- (5) Obtain blow-off plate. Align holes in surge valve to holes in blow-off plate. The blow-off plate must be installed to the surge valve with the round hole opening in the center of the blow-off plate facing the surge valve rubber diaphragm (Fig. 7).
- (6) Obtain gasket. Align the holes in the gasket to the turbo side of the blow-off plate. The crescent shaped hole in the gasket must align with the crescent-shaped hole in the blow-off plate and the surge valve flange of the compressor housing (Fig. 7).
- (7) Insert one bolt (provided in kit) through the surge valve, blow-off plate and gasket. Align the blow-off plate and surge valve to the turbo, align the vacuum hose fitting to the vacuum hose inlet position. Hand thread the bolt into the turbo housing, align the two remaining bolts, hand tighten all three bolts to attach the blow-off plate to the turbo (Fig 8). Torque to 68 in.-lbs.
- (8) Reconnect the surge valve vacuum hose (Fig. 6).
- (9) Install the clean air hose (Fig. 2).
- (10) Reinstall the battery, and reconnect to vehicle. (Fig. 1).

**Not legal for use on pollution-controlled vehicles, or vehicles registered for highway use.**

#### PT TURBO INSTALLATION

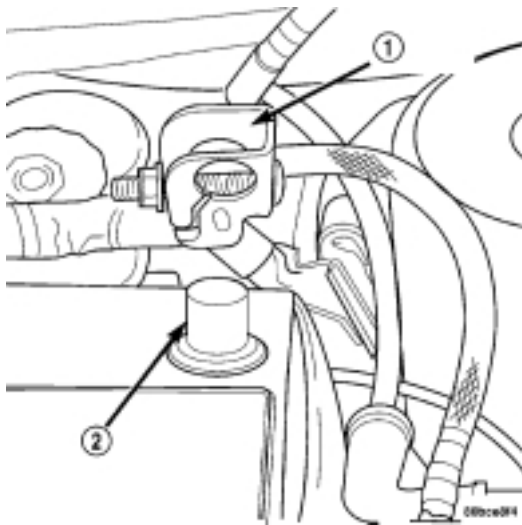
- (1) Remove the air cleaner housing (Fig. 3).
- (2) Remove the clean air hose (Fig. 4).
- (3) Disengage the Power Distribution Center (Fig. 5), release two clips, move PDC to the right for clearance (do not disconnect harness).
- (4) Disconnect surge valve vacuum hose rear underside of turbo (Fig. 6).
- (5) Remove the three attaching bolts that secure the surge valve to the turbo.
- (6) Obtain blow-off plate. Align the holes in the surge valve to the holes in the blow-off plate. The blow-off plate must be installed to the surge valve with the round hole opening in the center of the blow-off plate facing the surge valve rubber diaphragm (Fig. 7).
- (7) Obtain the gasket. Align the holes in the gasket to the turbo side of the blow-off plate. The crescent-shaped hole in the gasket must align with the crescent-shaped hole in the blow-off plate and the surge valve flange on the compressor housing (Fig. 7).
- (8) Insert one bolt (provided in kit) through the surge valve, blow-off plate and gasket. Align the blow-off plate and surge valve to the turbo. Align the vacuum hose fitting to the vacuum hose inlet position. Hand thread bolt into the turbo housing, align the two remaining bolts, hand tighten all three bolts to attach the blow-off plate to the turbo (Fig 8). Torque to 68 in.-lbs.
- (9) Install the clean air hose (Fig. 4).
- (10) Install the air cleaner housing (Fig 3).
- (11) Install the Power Distribution Center (Fig. 5).



INSTALLATION INSTRUCTIONS  
**BLOW-OFF VALVE CONVERSION KIT**  
**DODGE SRT-4/CHRYSLER PT TURBO**  
PART NUMBER P4510548

### BATTERY REMOVAL

**WARNING: TO PROTECT THE HANDS FROM BATTERY ACID, A SUITABLE PAIR OF HEAVY-DUTY RUBBER GLOVES, NOT THE HOUSEHOLD TYPE, SHOULD BE WORN WHEN REMOVING OR SERVICING A BATTERY. SAFETY GLASSES SHOULD ALSO BE WORN.**



- (1) Make sure ignition switch is in the OFF position and all accessories are OFF.
- (2) Open the hood.
- (3) Disconnect and isolate the battery negative cable, then the positive cable (Fig. 1).
- (4) Remove the thermal guard from battery.
- (5) Loosen the bolt and retainer that hold the battery down to the tray.
- (6) Lift the battery out of the battery tray and remove the battery from the vehicle.

### BATTERY INSTALLATION

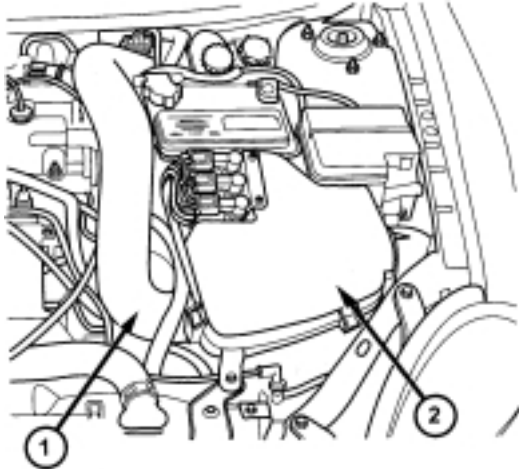
- (1) Install the battery in the vehicle, making sure that the thermal guard is present and the battery is properly positioned on the battery tray.
- (2) Install the battery hold-down clamp, making sure that it is properly positioned on the battery.
- (3) Connect the the battery cable clamps to the battery posts and make sure the top of the clamp is flush with or below the top of post (Fig. 2). Install the battery positive cable first.
- (4) Tighten the clamp nuts securely.

**Fig. 1 Disconnect And Isolate The Battery Negative Cable**

- ① Negative Cable
- ② Negative Battery Post



INSTALLATION INSTRUCTIONS  
**BLOW-OFF VALVE CONVERSION KIT**  
**DODGE SRT-4/CHRYSLER PT TURBO**  
PART NUMBER P4510548



6102973c

**Fig. 2 Clean Air Hose - SRT 4**

- ① Clean Air Hose
- ② Air Cleaner Housing Cover

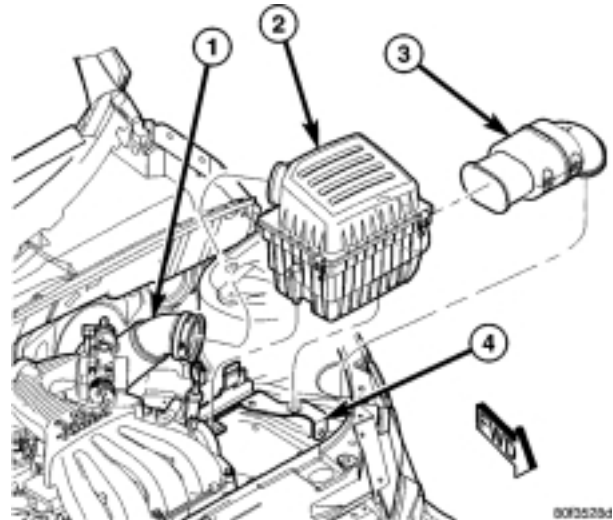
**AIR CLEANER HOUSING**

**REMOVAL**

- (1) Disconnect the throttle body air inlet hose/clean air hose from the air cleaner housing (Figs. 3 and 4).
- (2) Pull air the cleaner housing straight up to remove.
- (3) Remove the inlet duct from the air cleaner housing.

**INSTALLATION**

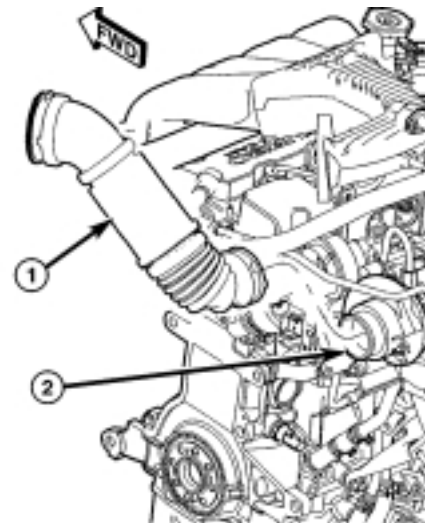
- (1) Install the inlet duct to the air cleaner housing.
- (2) Make sure the rubber grommets for the air cleaner housing lower pins are in place when reinstalling the air cleaner housing. The rubber grommets mount to the PDC bracket (Fig. 3).
- (3) Push the air cleaner housing down while aligning pins into the grommets.
- (4) Connect the throttle body air inlet hose/clean air hose to the air cleaner housing (Figs. 3 and 4).



6093523d

**Fig. 3 Air Inlet System - PT Cruiser**

- ① Clean Air Hose
- ② Air Cleaner Housing
- ③ Fresh Air Inlet Duct
- ④ PDC Mounting Bracket



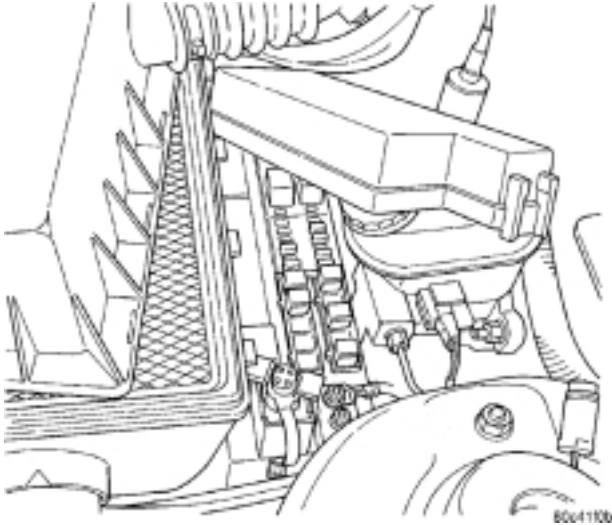
6093523e

**Fig. 4 Clean Air Hose - PT cruiser**

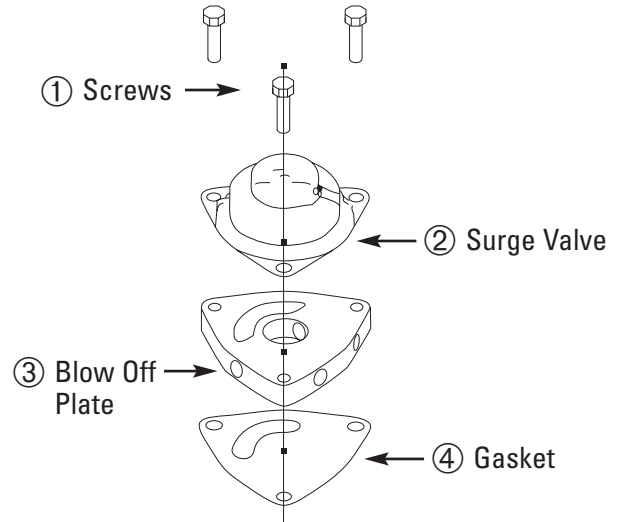
- ① Clean Air Hose
- ② Turbo Charger



INSTALLATION INSTRUCTIONS  
**BLOW-OFF VALVE CONVERSION KIT**  
**DODGE SRT-4/CHRYSLER PT TURBO**  
PART NUMBER P4510548

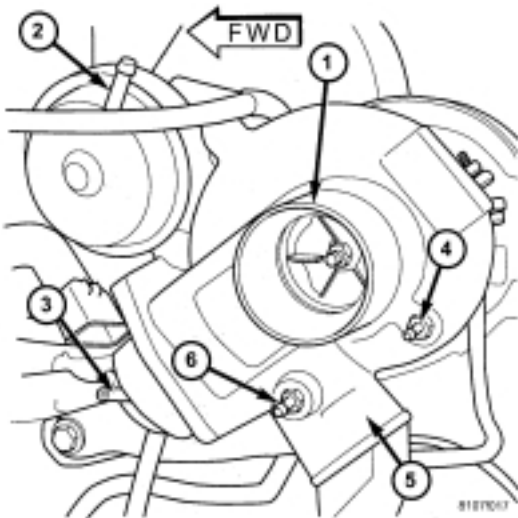


**Fig. 5 Power Distribution Center Location - PT Cruiser**



**Fig. 7 Surge Valve Location**

- ① Screws
- ② Surge Valve
- ③ Blow Off Plate
- ④ Gasket



**Fig. 6 Surge Valve Location - SRT 4 and PT Cruiser**

- ① Turbocharger Clean Air Inlet
- ② Wastegate Vacuum Hose Port
- ③ Surge Valve Vacuum Hose Port
- ④ Scroll Line Vacuum Hose Port
- ⑤ Turbocharger Outlet To Charge Air Cooler Hose
- ⑥ Compressor Outlet Vacuum Hose Port



**Fig. 8 Surge Valve Installed**